

# COUNTDOWN AND LAUNCH

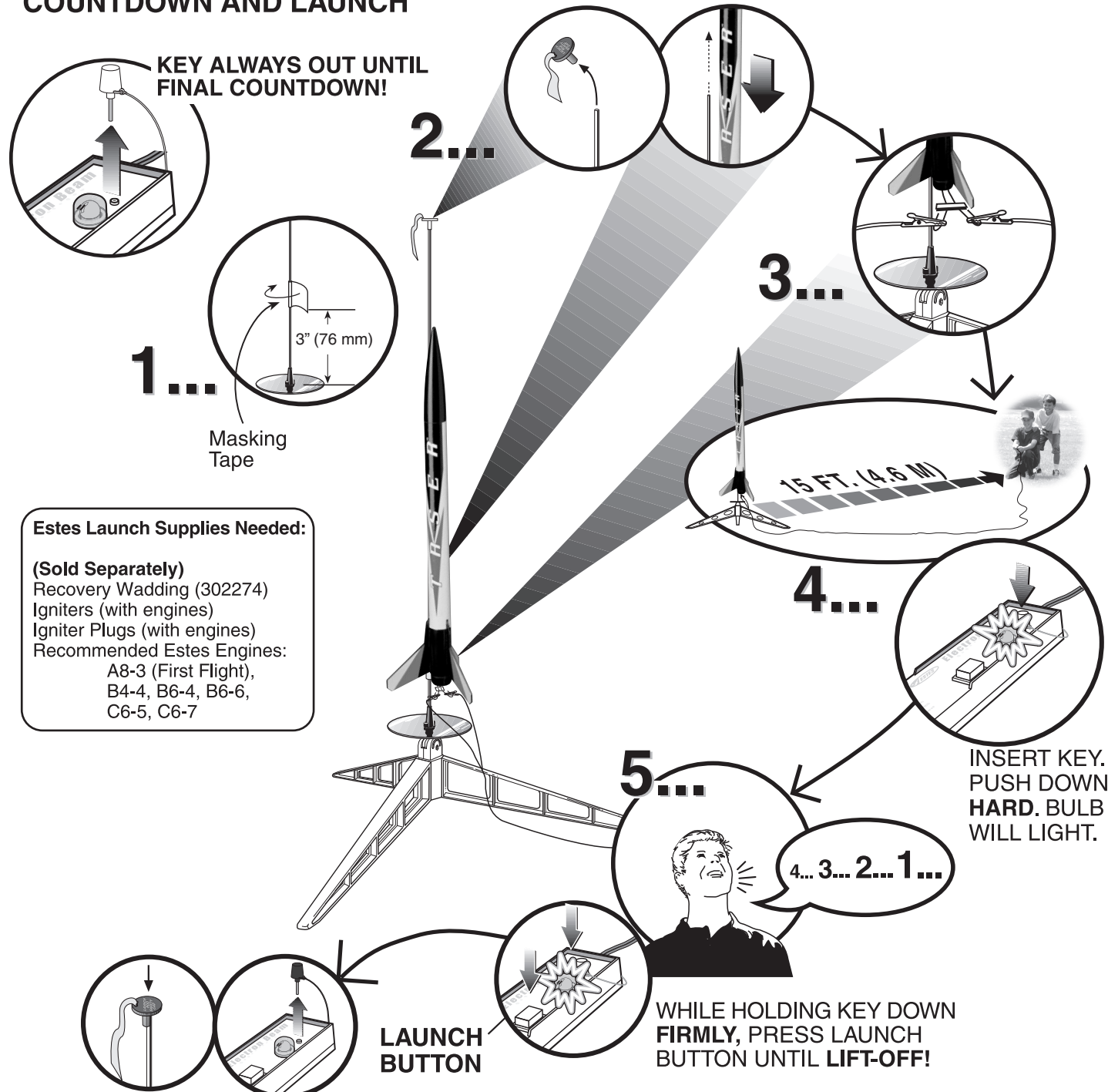

**KEY ALWAYS OUT UNTIL FINAL COUNTDOWN!**

2...

3...

4...

5...

4... 3... 2... 1...

Masking Tape

3" (76 mm)

INSERT KEY. PUSH DOWN HARD. BULB WILL LIGHT.

LAUNCH BUTTON

WHILE HOLDING KEY DOWN FIRMLY, PRESS LAUNCH BUTTON UNTIL LIFT-OFF!

### Estes Launch Supplies Needed:

- (Sold Separately)**  
 Recovery Wadding (302274)  
 Igniters (with engines)  
 Igniter Plugs (with engines)  
 Recommended Estes Engines:  
 A8-3 (First Flight),  
 B4-4, B6-4, B6-6,  
 C6-5, C6-7

## PRECAUTIONS



NO DRY GRASS OR WEEDS

### PRE-LAUNCH CHECK

For safety, never launch a damaged rocket. Check the rocket's body, nose cone and fins. Also, check the engine mount, recovery system and launch lug. Repair any damage before launching the rocket.

### FLYING YOUR ROCKET

Choose a large field (500 ft. [152 m] square) free of dry weeds and brown grass. The larger the launch area, the better your chance of recovering your rocket. Football fields and playgrounds are great. Launch only with little or no wind and good visibility.

Always follow the enclosed National Association of Rocketry (NAR) SAFETY CODE.

### MISFIRES

TAKE THE KEY OUT OF THE CONTROLLER. WAIT ONE MINUTE BEFORE GOING NEAR THE ROCKET! Disconnect the igniter clips and remove the engine. Take the plug and igniter out of the engine. If the igniter has burned, it worked but did not ignite the engine because it was not touching the propellant inside the engine. Put a new igniter all the way inside the engine without bending it. Push the plug in place. Repeat the steps under Countdown and Launch.



ESTES-COX CORP.  
 1295 H Street, PO Box 227  
 Penrose, CO 81240-0227  
 PRINTED IN CHINA

# TASER™ LAUNCH SET

FLYING MODEL ROCKET KIT INSTRUCTIONS  
 KEEP FOR FUTURE REFERENCE

#1491



SHOCK CORD MOUNT

SECTION 3

SECTION 2

SECTION 1



www.  
**Estes**  
 rockets  
 .com

**PARTS** Locate the parts shown below and lay them out on the table in front of you. DO NOT USE THIS DRAWING TO ASSEMBLE YOUR ROCKET.

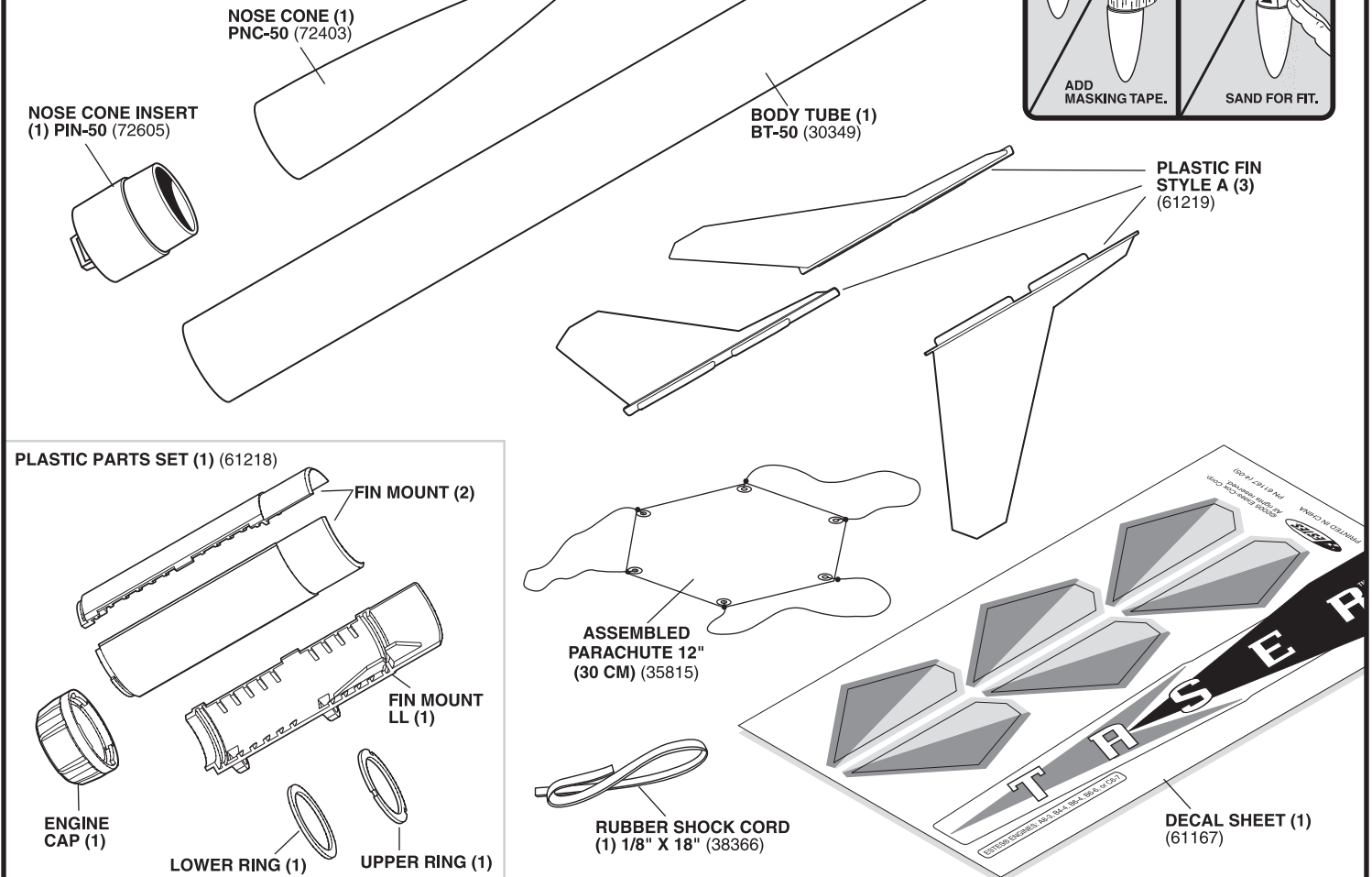

**SUPPLIES** In addition to the parts included in the kit you will also need:



SCISSORS



PENCIL



RULER



FINE SANDPAPER



PLASTIC CEMENT



MODELING KNIFE



MASKING TAPE



CARPENTER'S GLUE

# 1. ASSEMBLE FIN MOUNT

**NOTE:** Assemble all parts together without gluing first. Then, assemble with plastic cement.

**A.** Use a modeling knife to scrape flash (excess plastic) from edges of fin mounts (if required).

**B.** Lay out the three fin mounts as shown. Apply plastic cement in the grooved channels of all three (both upper and lower channels).

**C.** Apply plastic cement to the raised sections on one edge of each fin mount (the same side on all 3 sections).

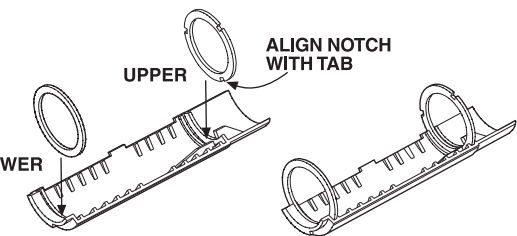

**D.** Place the upper ring (notched) in the upper channel and the lower ring in the lower channel of one fin mount.

**E.** Align the three fin mount sections with the rings in place and press together. Hold until cement sets completely (or use a rubber band). Let dry.

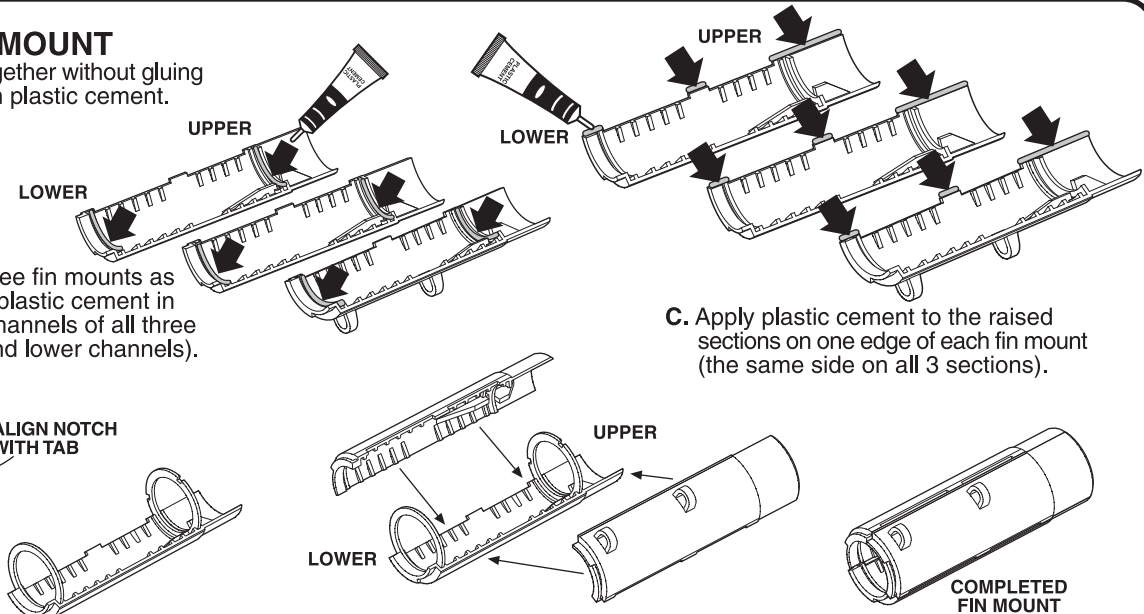

# 2. ATTACH BODY TUBE

**A.** Apply a ring of plastic cement just inside one end of body tube.

**B.** Insert the assembled fin mount into the body tube.

**C.** Wipe away any excess cement and let dry.

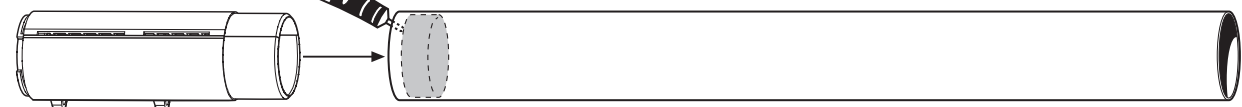

# 3. ATTACH FINS

**A.** Test fit each fin into the fin slots before gluing. Apply plastic cement along the root edge of each fin and reinsert. Be sure fins are straight. Let dry.

**NOTE:** Fins must be attached correctly for stable flight.

**B.** Make sure glue from step A is dry first so that the cap will not become glued in place. Attach engine cap and turn clockwise to lock in place.

**NOTE:** Scrape flash from shoulder of engine cap first (if required).

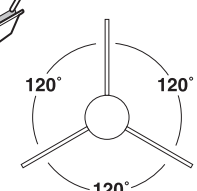

**DO NOT GLUE CAP TO ENGINE MOUNT!**

# 4. INSTALL SHOCK CORD MOUNT

**A.** Cut out shock cord mount from page 1.

**B.** Fold.

**C.** Apply glue. Fold forward.

**D.** Apply glue. Fold forward.

**E.** Squeeze tightly and hold for one minute.

**F.** Glue mount 1 1/2" (38 mm) inside upper body tube. Hold until glue sets. Let dry.



# 5. ASSEMBLE NOSE CONE

**A.** Apply a ring of plastic cement inside nose cone as shown.

**B.** Insert the nose cone insert into the nose cone and let dry.  
**NOTE:** Use only plastic cement for this step.

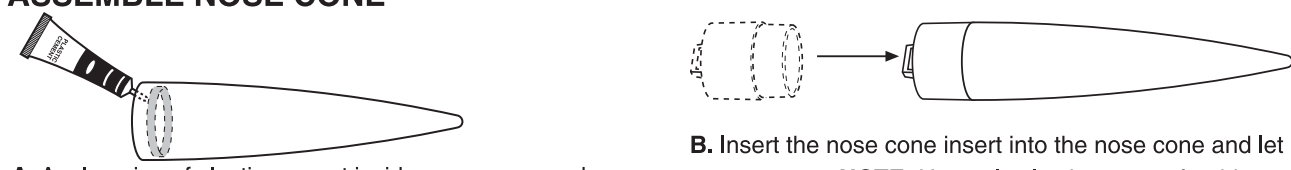

# 6. APPLY DECALS

**A.** Peel decals from backing sheet one at a time and apply to fins and body tube where shown.

**NOTE:** Apply engine sticker from decal sheet to body tube as an easy reference.



# 7. ATTACH PARACHUTE & SHOCK CORD

**A.** Form a loop with shroud lines.

**B.** Push loop through eyelet in nose cone.

**C.** Pass parachute through loop.

**D.** Pull tight.

**DOUBLE KNOT**

**E.** Tie free end of shock cord to nose cone. Use a double knot.

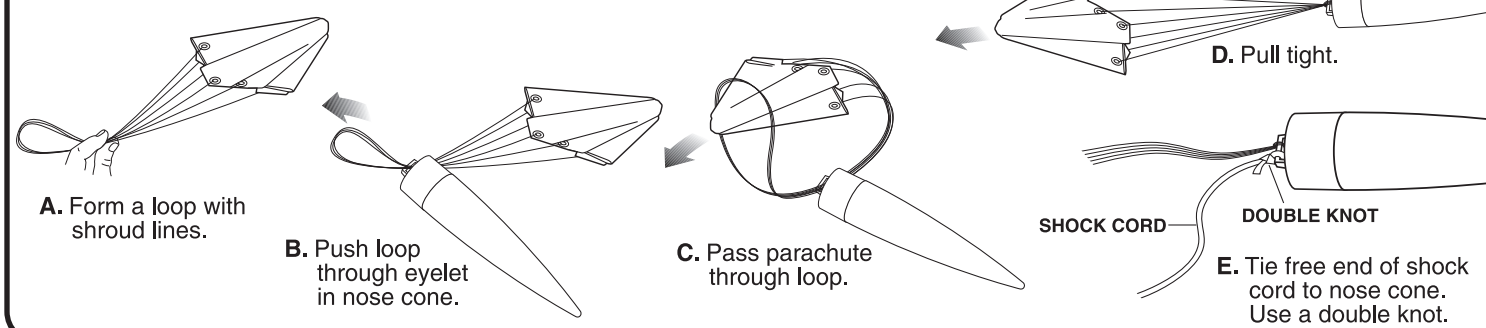

# 8. PREPARE PARACHUTE FOR FLIGHT

**A.** Insert 3-4 squares of loosely crumpled recovery wadding into rocket.

**B.** Spike.

**C.** Fold.

**D.** Roll.

**E.** Wrap lines loosely. Insert parachute, shock cord and nose cone into body tube.

**NOTE:** Recovery wadding and parachute must slide easily into body tube. If too tight, redo.

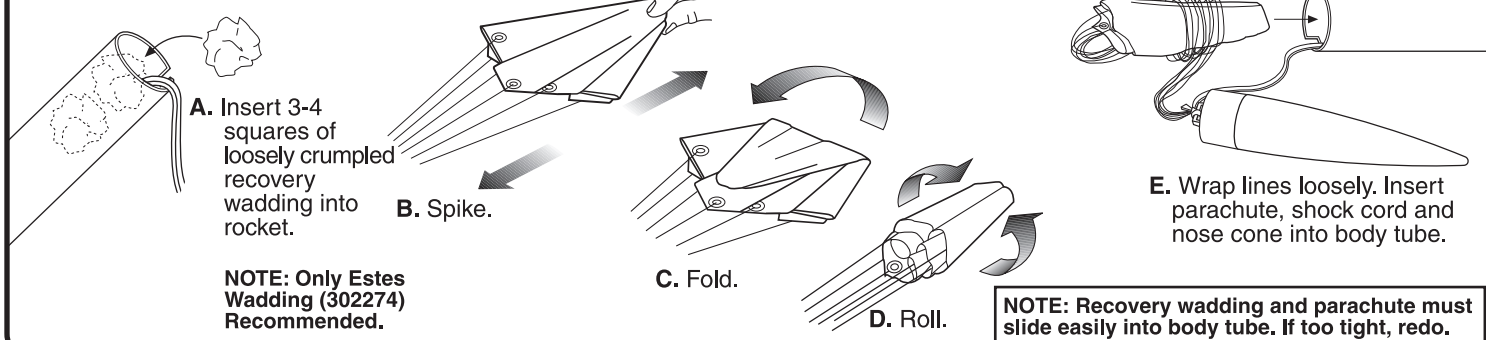

# 9. PREPARE ENGINE

**A.** Remove engine cap. Insert engine.

**B.** Replace engine cap.

**C.** Separate igniter & igniter plug.

**D.** Drop in igniter.

**E.** Insert igniter plug. Firmly push all the way in!

**F.** Gently bend igniter wires to form leads as shown.

**WARNING: FLAMMABLE**

To avoid serious injury, read instructions & NAR Safety Code included with engines. **PREPARE ENGINE ONLY WHEN YOU ARE OUTSIDE AT THE LAUNCH SITE PREPARING TO LAUNCH!** If you do not use your prepared engine, remove the igniter before storing engine.

